



UCF 200 PPSS Series (SUCTF 200)

Thermoplastic four-bolt flanged housing units, FDA & NSF approved grease.

Stainless steel normal duty bearing, set screw locking.

Housing: Reinforced PBT (polybutylene terephthalate), solid base.

Operating temperatures of the housing from -20 to +120 °C

Grease nipple: AISI 304 Stainless

Grease: Mobil FM 222 Food Grade FDA & NSF approved

Bearing Inserts:

Inner & outer races, balls: AISI 420-440 Stainless

Cage: AISI 302 Stainless

Seals: Rubber & AISI 302 Stainless

Set screws: AISI 420 Stainless

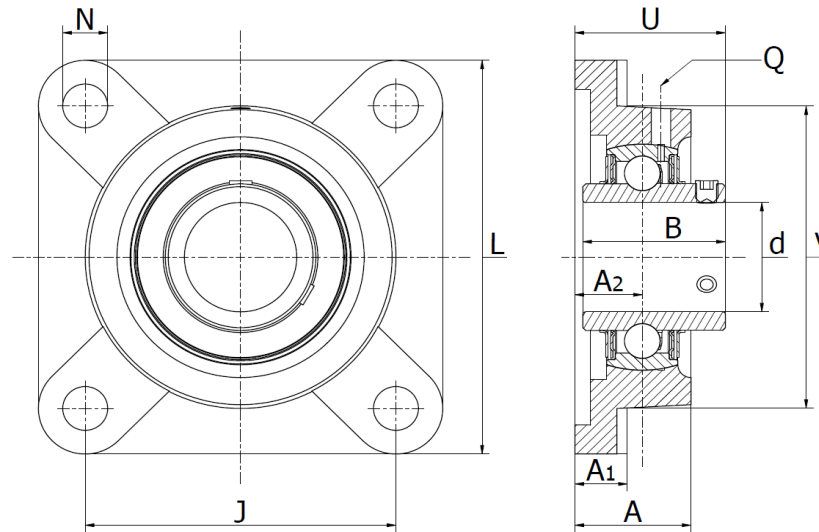
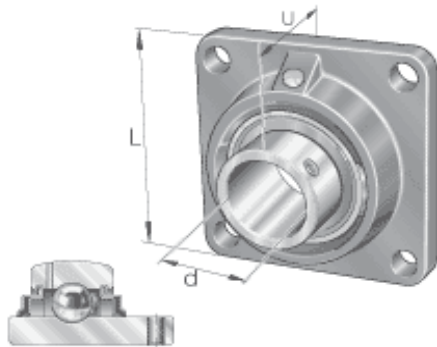

Part No.	Dimensions (mm)										Bolt Size	Bearing No.	Housing No.	Weight (kg)	Cover closed	Cover open
	d mm	L	J	B	A ₂	A ₁	A	U	N	Q						
UCF 204PPSS (SUCTF204)	20	86	63,5	31,0	18	14	27,8	33,3	11,0	M6	M10	UC 204 SS	TF204	0,30	EC204	EC204 OP
UCF 205PPSS (SUCTF205)	25	95	70	34,0	17	14,5	28,0	35,7	11,0	M6	M10	UC 205 SS	TF205	0,40	EC205	EC205 OP
UCF 206PPSS (SUCTF206)	30	107	83	38,0	19,2	14,3	31,5	40,2	11,0	M6	M10	UC 206 SS	TF206	0,70	EC206	EC206 OP
UCF 207PPSS (SUCTF207)	35	117	92	42,9	21,5	16	34,8	44,4	13,0	M6	M12	UC 207 SS	TF207	0,90	EC207	EC207 OP
UCF 208PPSS (SUCTF208)	40	128,5	102	49,2	23	17,5	36,5	51,2	14,0	M6	M12	UC 208 SS	TF208	1,10	EC208	EC208 OP
UCF 209PPSS (SUCTF209)	45	137	105	49,2	24	19,5	41,0	52,2	17,0	M6	M14	UC 209 SS	TF209	1,30	-	-
UCF 210PPSS (SUCTF210)	50	143	111	51,6	24	20	41,0	56,6	17,0	M6	M14	UC 210 SS	TF210	1,50	-	-