



UCFL 200 PPSS Series (SUCTFL 200 / RCJTY-TV-VA)

Thermoplastic two-bolt flanged housing units, FDA & NSF approved grease.

Stainless steel normal duty bearing, set screw locking.

Housing: Reinforced PBT (polybutylene terephthalate), solid base, reinforced bolt holes.

Operating temperatures of the housing from -20 to +120 °C

Grease nipple: AISI 304 Stainless

Grease: Mobil FM 222 Food Grade FDA & NSF approved

Bearing Inserts:

Inner & outer races, balls:

Cage:

Seals:

Set screws:

AISI 440C Stainless

AISI 302 Stainless

Rubber & AISI 302 Stainless

AISI 420 Stainless

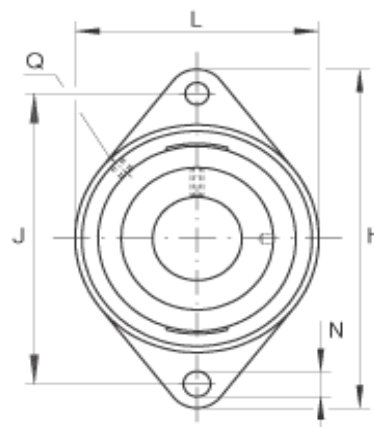
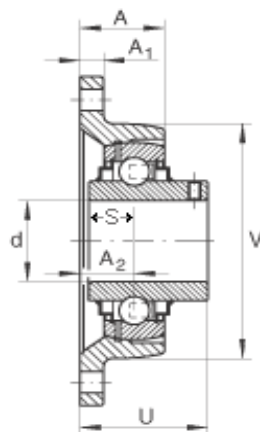
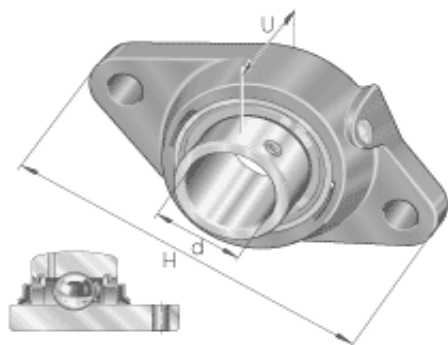

Part No.	d		Dimensions (mm)									Bolt Size	Bearing No.	Housing No.	Weight (kg)	Cover closed	Cover open
	mm	H	J	L	A ₂	A ₁	A	U	N	S	Q						
UCFL 204PPSS (SUCTFL204)	20	113	90	64	15,4	12	26,5	33,7	11	12,7	M6	M10	UC 204 SS	TFL204	0,3	EC204	EC204 OP
UCFL 205PPSS (SUCTFL205)	25	131	99	69,5	17	14	29,5	36,8	11	14,3	M6	M10	UC 205 SS	TFL205	0,4	EC205	EC205 OP
UCFL 206PPSS (SUCTFL206)	30	148	117	79	19	14	30,5	41,2	11	15,9	M6	M10	UC 206 SS	TFL206	0,7	EC206	EC206 OP
UCFL 207PPSS (SUCTFL207)	35	163,5	130	90	18	16	32,8	43,4	13	17,5	M6	M12	UC 207 SS	TFL207	0,9	EC207	EC207 OP
UCFL 208PPSS (SUCTFL208)	40	175	144	99	21,5	20	37,5	51,7	14	19	M6	M12	UC 208 SS	TFL208	1,1	EC208	EC208 OP