

SS 6200 2RS - Stainless Steel Single Row Ball Bearings

Shaft Sizes from 3 mm up to 60 mm.

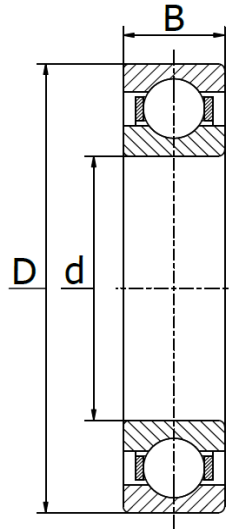

Inner & Outer Races: AISI 420-440 Stainless

Balls: AISI 420-440 Stainless

Seals: Rubber

Grease: FDA approved food grease

Operating temperature range: -30°C to +110°C

Part no.	Dimensions (mm)			Dyn. Load Rating kN	Static Load Rating kN	Maximum Speed (RPM)		Weight kg
	d	D	B			Grease	Oil	
SS 623 2RS	3	10	4	0,36	0,11	38000	48000	0,002
SS 624 2RS	4	13	5	0,74	0,25	36000	45000	0,003
SS 625 2RS	5	16	5	1,43	0,63	32000	40000	0,005
SS 626 2RS	6	19	6	1,53	0,59	28000	36000	0,008
SS 627 2RS	7	22	7	1,99	0,78	26000	34000	0,013
SS 628 2RS	8	24	8	2,47	1,12	24000	32000	0,017
SS 629 2RS	9	26	8	3,97	1,96	22000	30000	0,020
SS 6200 2RS	10	30	9	5,40	2,10	19000	26000	0,030
SS 6201 2RS	12	32	10	5,30	2,80	18000	24000	0,040
SS 6202 2RS	15	35	11	7,10	3,20	17000	22000	0,045
SS 6203 2RS	17	40	12	8,55	4,30	16000	20000	0,060
SS 6204 2RS	20	47	14	11,40	5,80	14000	18000	0,100
SS 6205 2RS	25	52	15	12,60	7,00	12000	16000	0,120
SS 6206 2RS	30	62	16	17,30	10,80	10000	13000	0,190
SS 6207 2RS	35	72	17	22,90	13,80	8800	10000	0,270
SS 6208 2RS	40	80	18	26,10	16,40	7700	9200	0,370
SS 6209 2RS	45	85	19	28,00	18,00	6800	8200	0,420
SS 6210 2RS	50	90	20	32,50	21,10	6100	7300	0,470
SS 6211 2RS	55	100	21	33,14	23,20	5500	6600	0,602
SS 6212 2RS	60	110	22	41,14	28,80	5000	5500	0,804