

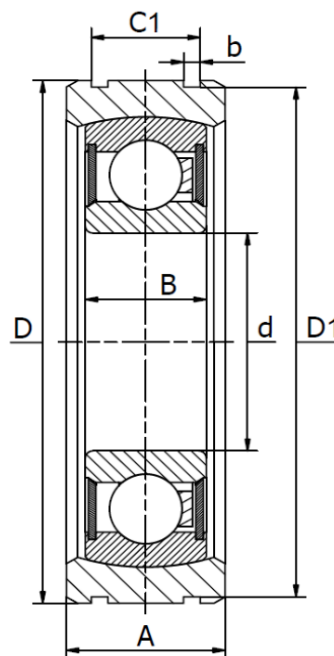

## BE ... Series

Steel aligning ring, P seals. Temperature range -30°C to +110°C



Product No.	d (mm)	Dimensions (mm)						D <sub>1</sub>	Bearing No.	Housing No.	Weight (kg)
		D	A	B	b	C <sub>1</sub>					
BE20	20	55	16	14	1,35	11,2	53,5	CS 204	PE-BE 20 O.L	0,19	
BE25	25	62	17	15	1,9	11,2	60,5	CS 205	PE-BE 25 O.L	0,25	
BE30	30	72	21	16	1,9	14,4	70,2	CS 206	PE-BE 30 O.L	0,37	
BE35	35	80	21	17	1,9	14,4	78,2	CS 207	PE-BE 35 O.L	0,45	
BE40	40	90	25	18	2,7	15,4	88,0	CS 208	PE-BE 40 O.L	0,63	