

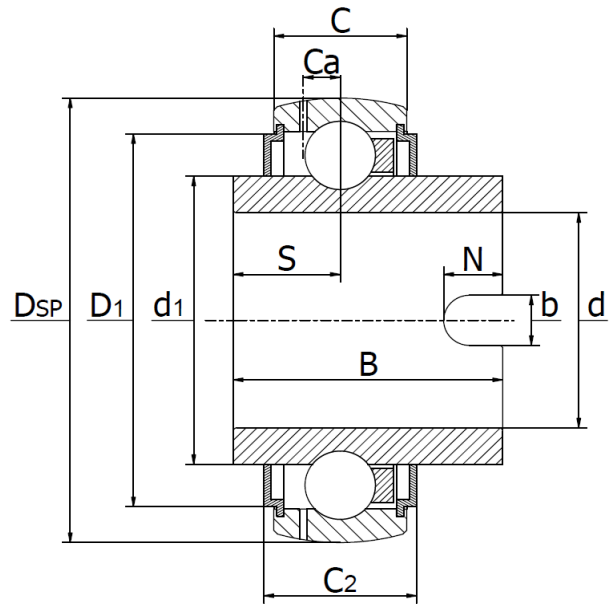

GLE..KRRB - Radial insert ball bearings

Spherical outer ring, non-locating bearing, drive slot in inner ring, lithium based NLGI 2/3 grease.
Temperature range -30°C to +110°C.

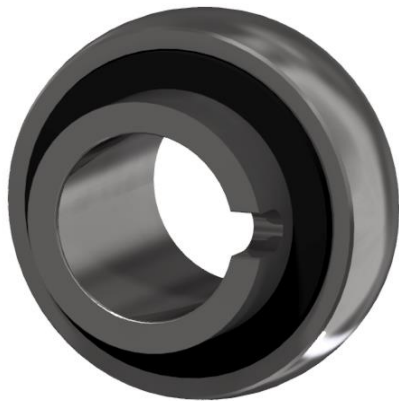

Product No.	Dimensions (mm)											Weight (kg)	Basic radial load rating	
	d	D _{SP}	B	b	C	C ₂	Ca	D ₁	d ₁	N	S		Dynamic (N)	Static (N)
GLE20KRRB	20	47	34,1	7	14	16,6	4	37,4	27,6	7	15,6	0,15	12.800	6.600
GLE25KRRB	25	52	34,9	7	15	16,7	3,9	42,5	33,8	8	14,7	0,19	14.000	7.800
GLE30KRRB	30	62	36,5	7	18	20,7	4,7	52,0	40,2	8	14,5	0,30	19.500	11.300
GLE35KRRB	35	72	37,7	7	19	22,5	5,6	60,3	46,8	8	15,7	0,43	25.500	15.300
GLE40KRRB	40	80	42,9	7	21	23,5	6,4	68,3	52,3	9	15,9	0,57	32.500	19.800
GLE45KRRB	45	85	42,9	7	22	26,4	6,4	72,3	57,9	9	17,4	0,66	32.500	20.400
GLE50KRRB	50	90	49,2	7	22	26,4	6,9	77,3	62,8	10	19,0	0,76	35.000	23.200
GLE60KRRB	60	110	61,9	9	24	29,0	7,2	95,9	76,5	12	24,6	1,46	52.000	36.000
GLE70KRRB	70	125	68,2	9	28	32,0	8,9	109,0	85,2	12	27,0	1,90	62.000	44.000