

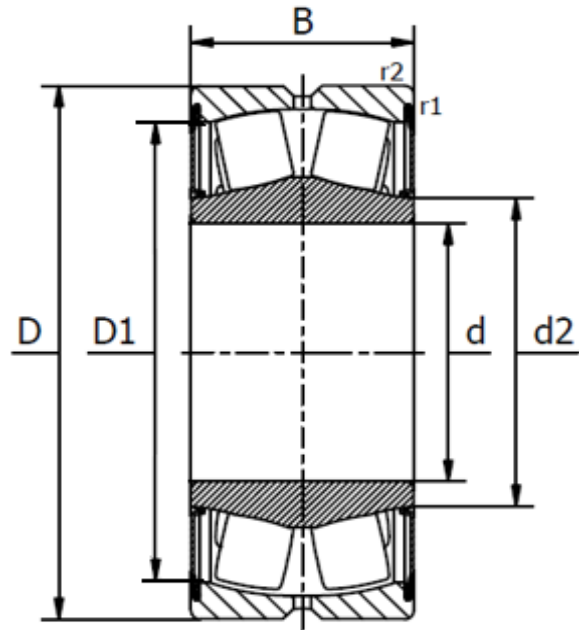

BS2-2200-2CS Series

Spherical roller bearings, cylindrical bore, seal on both sides, lithium based NLGI 2/3 grease, temperature range -30°C to +110°C.



Bearing No.	Dimensions (mm)					Basic load ratings (kN)		Fatigue load limit P_u (kN)	Limiting speed r/min.	Weight (kg)
	d	D	B	D_1	d_2	Dynamic C_r	Static C_{or}			
BS2-2205-2CS	25	52	23	46,6	30,0	49,0	44	4,8	3600	0,26
BS2-2206-2CS	30	62	25	55,7	36,0	64,0	60	6,4	3150	0,34
BS2-2207-2CS	35	72	28	63,7	43,0	86,5	85	9,3	2700	0,52
BS2-2208-2CS	40	80	28	73,0	47,0	96,5	90	9,8	2600	0,57
BS2-2209-2CS	45	85	28	77,1	53,0	102,0	98	10,8	2550	0,66
BS2-2210-2CS	50	90	28	82,1	58,0	104,0	108	11,8	2440	0,70
BS2-2211-2CS	55	100	31	91,9	64,0	125,0	127	13,7	2250	1,00
BS2-2212-2CS	60	110	34	102,0	69,0	156,0	166	18,6	2030	1,30
BS2-2213-2CS	65	120	38	111,0	76,0	193,0	216	24,0	1740	1,60
BS2-2214-2CS	70	125	38	115,0	80,0	208,0	228	25,5	1670	1,80
BS2-2215-2CS	75	130	38	119,0	84,0	212,0	240	26,5	1630	2,10
BS2-2216-2CS	80	140	40	128,0	91,5	236,0	270	29,0	1540	2,40
BS2-2217-2CS	85	150	44	138,0	98,0	285,0	325	34,5	1300	3,00
BS2-2218-2CS	90	160	48	148,0	102,0	325,0	375	39,0	1300	3,70
BS2-2220-2CS	100	180	55	162,0	114,0	425,0	490	49,0	1140	5,35

Spherical roller bearings have two rows of rollers with a common sphered raceway in the outer ring and two inner ring raceways inclined at an angle to the bearing axis. This gives them an attractive combination of design features making them irreplaceable in many demanding applications. They are self-aligning and consequently insensitive to misalignment of the shaft relative to the housing and to shaft deflection or bending. Spherical roller bearings are leading in design and can, in addition to high radial loads, accommodate high axial loads acting in both directions.

The bearings in this catalogue are sealed with contact seals on both sides. The seals are reinforced with sheet steel and made of an oil and wear-resistant acrylonitrile butadiene rubber (NBR).