

SNHF 200 FS Series - Plummer block housings (SNH/SNL/SNV)

For spherical ball and roller bearings on a cylindrical shaft, with FS-felt seals, housing based on the SNHF 500 series, cast iron GG 20.

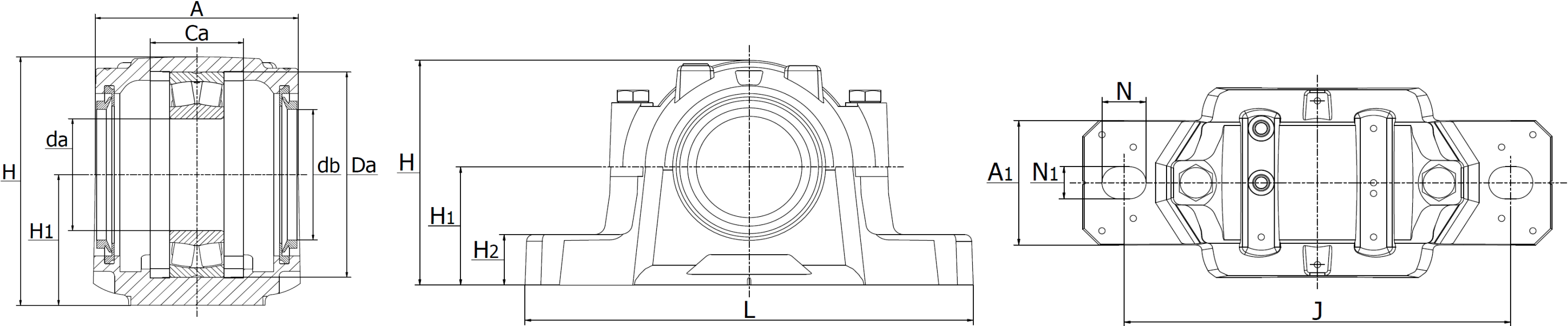

Part	Shaft size (mm)		Dimensions (mm)												Mounting	Bearings	Fixing	Housing	Felt	Covers	Weight
No.	da	db	A	A1	A2	Ca	Da	H	H1	H2	J	L	N	N1	Bolt		Rings	No.	Seals		(kg)
SNHF 206 FS	30	35	77	52	89	32	62	89	50	22	150	185	20	15	M12	1206	2 x FR 62-8	SNHF 506-605	FS	ASNH506-605	1,9
																2206	2 x FR 62-6				
																22206	2 x FR 62-6				
SNHF 207 FS	35	45	82	52	96	34	72	93	50	22	150	185	20	15	M12	1207	2 x FR 72-8.5	SNHF 507-606	FS	ASNH507-606	2,1
																2207	2 x FR 72-3.5				
																22207	2 x FR 72-5.5				
SNHF 208 FS	40	50	85	60	99	39	80	107	60	25	170	205	20	15	M12	1208	2 x FR 80-10.5	SNHF 508-607	FS	ASNH508-607	2,75
																2208	2 x FR 80-8				
																22208	2 x FR 80-8				
SNHF 209 FS	45	55	85	60	97	30	85	109	60	25	170	205	20	15	M12	1209	2 x FR 85-5.5	SNHF 509	FS	ASNH509	2,75
																2209	2 x FR 85-3.5				
																22209	2 x FR 85-3.5				
SNHF 210 FS	50	60	90	60	102	41	90	113	60	25	170	205	20	15	M12	1210	2 x FR 90-10.5	SNHF 510-608	FS	ASNH510-608	3
																2210	2 x FR 90-9				
																22210	2 x FR 90-9				
SNHF 211 FS	55	65	95	70	107	44	100	127	70	28	210	255	24	18	M16	1211	2 x FR 100-11.5	SNHF 511-609	FS	ASNH511-609	4,2
																2211	2 x FR 100-9.5				
																22211	2 x FR 100-9.5				

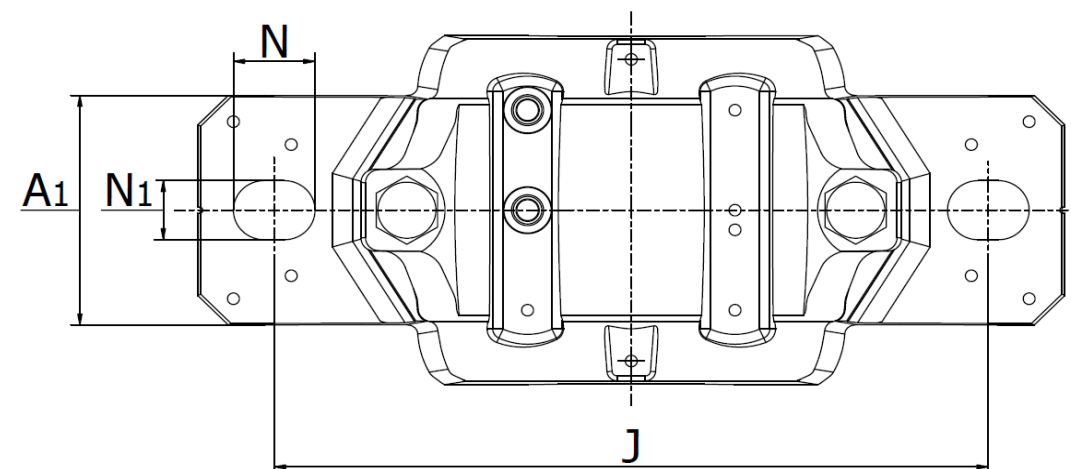
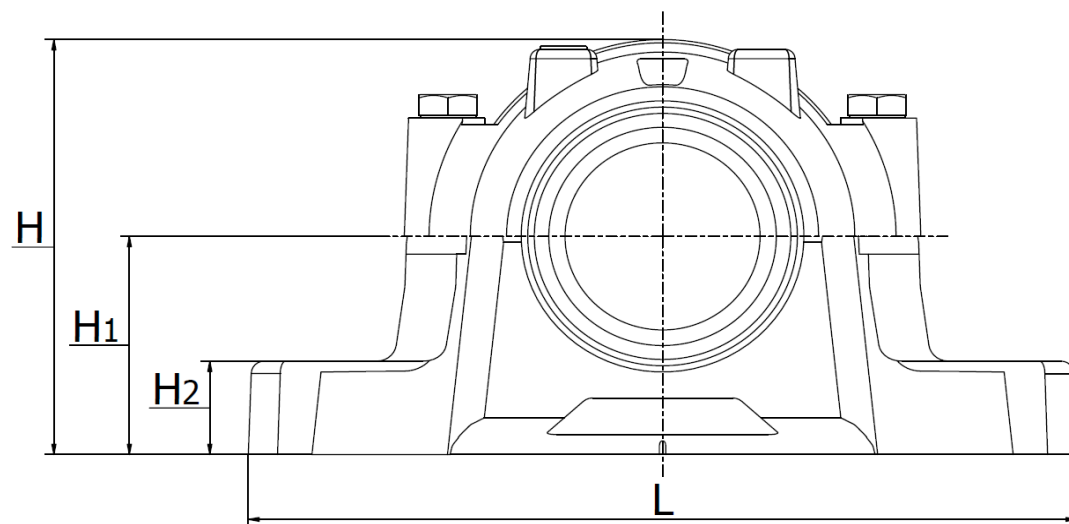
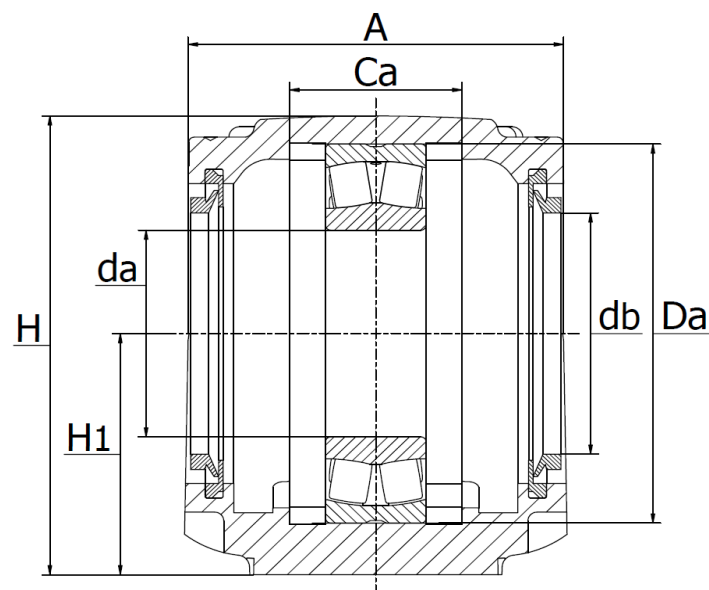

Part	Shaft size (mm)		Dimensions (mm)											Mounting	Bearings	Fixing	Housing	Felt	Covers	Weight (kg)	
No.	da	db	A	A1	A2	Ca	Da	H	H1	H2	J	L	N	N1		Bolt	Rings	No.			Seals
SNHF 212 FS	60	70	105	70	117	48	110	133	70	30	210	255	24	18	M16	1212	2 x FR 110-13	SNHF 512-610	FS	ASNH512-610	4,75
																2212	2 x FR 110-10				
																22212	2 x FR 110-10				
SNHF 213 FS	65	75	110	80	122	51	120	148	80	30	230	275	24	18	M16	1213	2 x FR 120-14	SNHF 513-611	FS	ASNH513-611	6,1
																2213	2 x FR 120-10				
																22213	2 x FR 120-10				
SNHF 215 FS	75	85	115	80	133	56	130	154	80	30	230	280	24	18	M16	1215	2 x FR 130-15.5	SNHF 515-612	FS	ASNH515-612	6,6
																2215	2 x FR 130-12.5				
																22215	2 x FR 130-12.5				
SNHF 216 FS	80	90	120	90	138	58	140	175	95	32	260	315	28	22	M20	1216	2 x FR 140-16	SNHF 516-613	FS	ASNH516-613	9
																2216	2 x FR 140-12.5				
																22216	2 x FR 140-12.5				
SNHF 217 FS	85	95	125	90	143	61	150	183	95	32	260	320	28	22	M20	1217	2 x FR 150-16.5	SNHF 517	FS	ASNH517	9,5
																2217	2 x FR 150-12.5				
																22217	2 x FR 150-12.5				
SNHF 218 FS	90	100	140	100	158	65	160	193	100	35	290	345	28	22	M20	1218	2 x FR 160-17.5	SNHF 518-615	FS	ASNH518-615	11,8
																2218	2 x FR 160-12.5				
																22218	2 x FR 160-12.5				
																23218	2 x FR 160-6.25				